

**ITEM 5. MOBILE CRANES – TEMPORARY ROAD CLOSURES – BRIDGE  
LANE SYDNEY**

**TRIM RECORD NO: 2016/666576**

**RECOMMENDATION**

It is recommended that the Committee endorse the temporary road closure of Bridge Lane, between Tank Stream Way and Bridge Street, Sydney, on Saturday 4 March 2017 and 11 March 2017 from 7am to 3pm, subject to the following conditions:

- (A) The Applicant must comply with the temporary road closure conditions as mentioned in Schedule C of this Agenda.
- (B) The Applicant must comply with any other conditions imposed by City's Construction Regulation Unit.
- (C) The Applicant has indicated Saturday 18 March 2017 as an alternative date for the above work as a contingency for inclement weather.
- (D) The Applicant must contact Sydney City Police to obtain a separate police permit and to discuss deployment of user pay police for the road closure.
- (E) The Applicant is to obtain a Road Occupancy Licence from the Transport Management Centre prior to commencement of works.
- (F) If the above closure dates conflict with any works associated with the CBD and South East Light Rail (CSELR) project, Sydney City Centre Access Strategy (SCCAS) or any other major works or special events, they may be changed to new dates in consultation with the Transport Management Centre and Sydney City Police.
- (G) The Applicant must provide a telephone number of the supervisor responsible for the proposed closure and include contact details in the notification letters to be distributed to affected stakeholders.

**VOTING MEMBERS FOR THIS ITEM**

<b><i>Voting Members</i></b>	<b><i>Support</i></b>	<b><i>Object</i></b>
City of Sydney		
Roads and Maritime Services		
NSW Police – Sydney City		
Representative for the Member for Sydney		

**DECISION**

**BACKGROUND**

Retro Traffic has applied for the temporary road closure of Bridge Lane, between Tank Stream Way and Bridge Street, Sydney, on Saturday 4 March 2017 and 11 March 2017 from 7am to 3pm.

**COMMENTS**

The proposed temporary road closure is required to allow a mobile crane to lift building materials at 5-11 Bridge Street, Sydney.

The Applicant has provided a site-specific Traffic Control Plan (TCP) that includes details of barricades, signs, flagmen and other traffic devices to implement the proposed road closure.

There are currently no other approved temporary road closures proposed to take place on the same day in close proximity of this closure.

The temporary road closure will not affect any other properties, as local access will be provided at all times and alternative access routes are available nearby.

A Traffic Management Plan (TMP) for the temporary road closure was approved by Roads and Maritime Services (RMS) on 9 February 2017.

**CONSULTATION**

The Applicant will be required to notify affected stakeholders as stipulated in Schedule C.

**FINANCIAL**

All costs associated with the proposed closure will be borne by the Applicant.

**ATTACHMENTS**

Mobile Cranes – Temporary Road Closures – Bridge Lane Sydney

Shan Shanmugalingam, Technical Support Officer

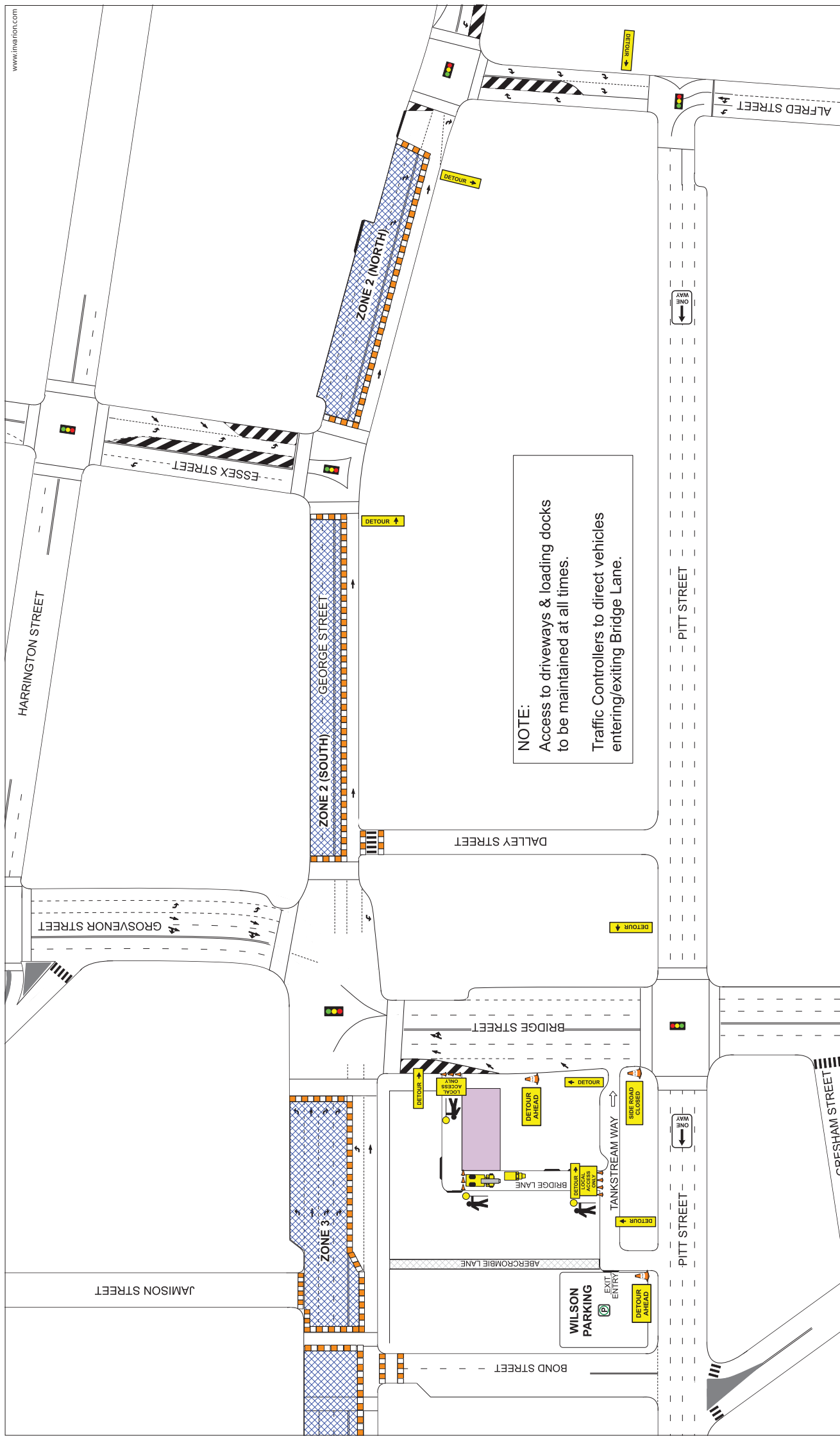

**TRAFFIC CONTROL PLAN MODIFICATION (minor onsite)**

Modified By: .....

Implement TCP Ticket No: .....

Date: ..... Time: .....

Signature: .....

**Project:** Retro Traffic Project: Eagle Rigging  
**Author:** Sarah Cooney  
**Drawn By:** Sarah Cooney  
**License No:** 2273016584  
**TCP No:** RT-ER-0736  
**Client:** Eagle Rigging Pty Ltd

**Comments:**  
 Location: Bridge Lane, Sydney 2000  
 Task: Delivery of steel material to roof of building  
 Traffic Control Required: Road Closure with driveway management;  
 Pedestrian Management

Note:  
 All sign spacing & taper lengths are in accordance with Australian Standards AS1742.03 and RMS TCWS Manual 4.0. Distances between signs may vary due to site constraints. Marked vehicle locations are not to scale.

**Designed by:** *[Signature]*  
 Design & Inspect Ticket No: 2273016584

**Checked by:** *[Signature]*  
 Design & Inspect Ticket No: 2253014469

